



# GOLD FIELD NOTES

EL DORADO CHAPTER ☼ CALIFORNIA NATIVE PLANT SOCIETY ☼ NOVEMBER-DECEMBER 2008

## EL DORADO CHAPTER AWARDED GRANT TO START NATIVE PLANT AND WATER-WISE GARDENING HOMEOWNER CONSULTATION SERVICE

by Rosemary Carey, Program Manager

### CALENDAR

#### November 18 (Tuesday)

Monthly program.  
Member potluck and slide show.  
See inside for details.

#### January 17-19 (Sat.—Mon.)

CNPS conference  
CNPS 2009 Conservation Conference: Strategies and Solutions.  
Sacramento, CA. <http://www.cnps.org/cnps/conservation/conference/2009/>

#### January 20 (Tuesday)

Monthly program.  
Valerie Hipkins talks about NFGEL and native plants. See inside for details.

#### February 17 (Tuesday)

Monthly program.  
Rosemary Carey introduces the Native Plant and Water-wise Gardening Project.

#### March 28-29 (Saturday-Sunday)

Symposium.  
Growing Natives: Celebrating California's Beauty in Dry Times.  
Held in the East Bay Area. See inside for details.



Monthly programs are held on the third Tuesday of each month with the exception of August and December. Programs begin at 7 PM and are held at the Placerville Library, 345 Fair Lane Placerville, CA.

**For updates between newsletters**  
[www.eldoradocnps.org](http://www.eldoradocnps.org)

In early October, the El Dorado Chapter was awarded a \$25,000 grant to begin a Sierra Nevada Yard and Garden Program for El Dorado County homeowners. This grant is one of only four grants awarded in the Sierra Nevada Conservancy Region, an area which stretches from Kern to Modoc Counties and includes the Sierra Nevada and southern Cascade Ranges in California. Funding for this project will be provided by the Sierra Nevada Alliance and the Sierra Nevada Conservancy, an agency of the State of California.

The El Dorado Chapter Sierra Nevada Yard and Garden Program will have two components: a tour of native plant gardens in El Dorado County to be held on Sunday, April 26<sup>th</sup>, 2009, and a homeowner consultation service. Examples of gardens in many different situations are being sought for the tour: under shade, on serpentine, riparian, etc. Gardens need not be composed only of native plants: perhaps you have a particularly good example of a mature flannel bush or some other specimen native plant so that its final height and width can be appreciated. Or perhaps you have an established lemonade berry or hollyleaf cherry hedge that could inspire someone to try native shrubs instead of Photinia. Gardens also do not need to be spectacular or in a finished state – they can be works in progress. It is more important that people be willing to share their enthusiasm and love of gardening with native plants: - whether it be because they are low-maintenance, deer resistant, water conserving, or attract birds and butterflies - and the benefit of their hard-won experience on which species are the toughest and most reliable. People willing to host the “Going Native Garden Tour” will be given a \$100 honorarium to purchase plants, labels, drip irrigation or other garden supplies and \$25 for beverages, snacks, cups and napkins. Please contact me at rose-

marycarey@comcast.net or at 530.620.3631 to host. In addition, since the “Going Native Garden Tour” will be held on one day only, the Chapter is also partnering with the El Dorado Resource Conservation District, donating \$1100 to buy and install new plant labels, replace dead plants, and mulch at the Placerville Library Xeriscape Garden since it functions as a year-round community resource.

The Sierra Nevada Yard and Garden Homeowner Consultation Service, which will be free to western and central El Dorado County homeowners, will begin in early spring 2009. The primary focus will be on recommending native plant and, to a lesser extent, water-wise (a.k.a. drought-adapted) introduced plants for the various problem situations found in home landscapes. I am especially pleased to announce that the other home consultant will be Steve Dowty, a founding chapter member with deep expertise in rhizomatous grasses, graminoids (sedges and rushes), and herbaceous species suitable for revege-

Sample site plan: Foothill oak woodland

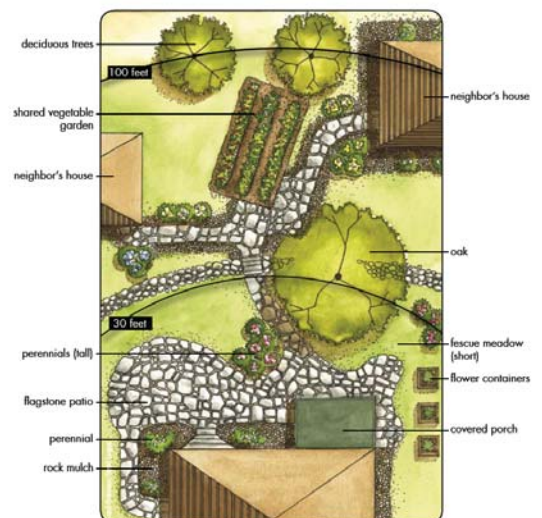

Rolling hills and sturdy oaks are some of the California landscape. In this sample site plan a tall oak is the central feature of three adjacent yards. In the sample landscape there are no oaks, but also a vegetable garden, a short oak well and well-tended. There are all oaks, common ways to utilize small outdoor space.

## Water-wise Gardening

(continued from page 1)

tating challenging sites. Steve also has a particular interest in reclaiming incising streams, using graminoids to capture and hold sediment and rebuild flood plains. Other topics to be covered during the home consultation will include native plants and wildlife (both pest protection measures and plant species having high wildlife value), reducing storm runoff by constructing low-tech and low cost water infiltration systems, appropriate methods of slope stabilization for moderate, steep and extremely steep slopes, drip irrigation basics, and wildfire defensible space guidelines. A minimum of thirty five homeowner consultations will be completed during the spring and summer of 2009. Homeowners will receive a site plan with appropriate plant species recommendations shown which they will be able to plant in fall 2009, the beautiful full color book *Sierra Nevada Yard and Garden Guide* produced by the Sierra Nevada Alliance, and an information booklet of El Dorado County resources. Homeowner consultation enrollment is now open at the email and phone number given above.

A presentation kicking off the Sierra Nevada Yard and Garden Homeowner Consultation Program will be given on February 17<sup>th</sup>, 2009 at the general meeting. Please come and share your ideas for this exciting new Chapter program for El Dorado County.

*Editor's note: This is an exciting opportunity for the El dorado Chapter and our community. We owe a hearty thank you to Rosemary Carey who developed this successful grant proposal.*

## NEW PUBLICATION SIERRA NEVADA YARD & GARDEN: A HOME- OWNER'S GUIDE TO LANDSCAPING IN THE SIERRA

The Sierra Nevada Alliance presents a new, first of its kind resource helping Sierra homeowners create a beautiful yard and garden that guards against wildfire, needs little maintenance, flourishes with native and adapted plants, exists in harmony with wildlife, and protects and conserves Sierra water—in other words, a Sierra friendly yard and garden .

## FALL PLANT SALE — A ROUSING SUCCESS

Our 2008 Fall Native Plant Sale was held on October 11 at the El Dorado County fairgrounds. Thanks to the work put in by all of our marvelous volunteers, we were able to offer a wonderful and varied selection of California native plants that grow well in El Dorado County. Ryan Wimmer brought conifers. Steve Dowty sold graminoids, groundcovers and flowering plants. Annie Walker contributed oaks. Ray Griffiths sold lots of Redbuds. Other members brought in a

little of this or a little of that, and Brian Austin brought a little of everything. We rounded out our selection with plants propagated by three wholesale native plant nurseries. We had some unusual offerings, including Mountain Mahogany, Giant Chain Fern and *Cornus nuttallii* - that's the Dogwood tree that is turning the woods around Jenkinson Reservoir bright scarlet this month. We sold native bulbs and wildflower seeds, books and posters, and Rosemary Carey took several orders for her new landscape consultation service. I was encouraged by the number of drought-tolerant plants that people bought. If California's environment is to have a healthy future, drought-tolerant landscaping must become the norm rather than the exception. Our plant sales are a great opportunity to teach people about gardening in harmony with nature, using less water and fewer chemicals, and benefiting wildlife in the process. Plant sale volunteers, pat yourselves on the back. Ya done good!!

Shellie Perry  
Plant Sale Coordinator

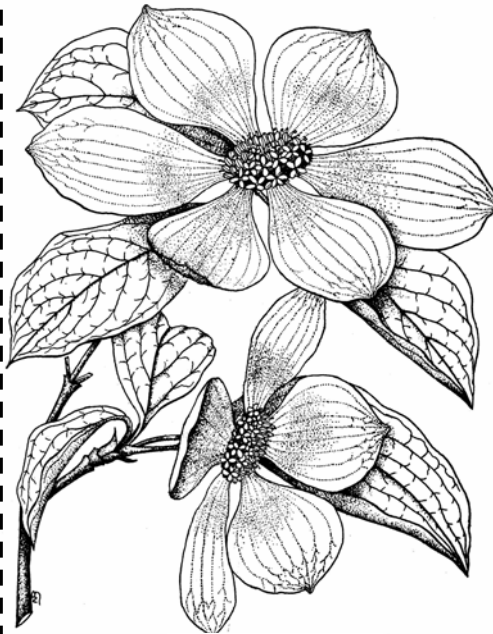

*Cornus nuttallii*

Developed for yards and gardens throughout the 400 mile long Sierra and Northern Cascade mountain ranges, the guide offers specific, local information for Sierra residents from the foothills to the high country. It includes specifics for Sierra vegetation zones which include the foothills, mixed conifers, montane, upper montane and alpine environment, eastern Sierra communities and Modoc Plateau. Get real-life examples from featured Sierra homeowners living at 900 feet to 6,200 feet in elevation.

This new guide forms the basis of the consultation program mentioned on page 1 of this newsletter. The guide is free to download or can be purchased at: <http://www.sierranevadaalliance.org/publications/SNLG/>

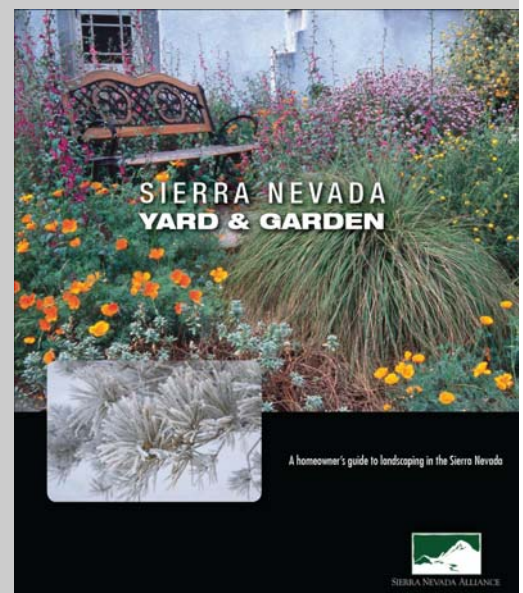

## OFFICER ELECTIONS COMING IN NOVEMBER!

On November 18 at the chapter meeting, we will be holding elections for 2009 officers (President, Vice-president, Secretary, and Treasurer).

We are seeking volunteers for these positions, especially for the role of Treasurer. You must be a current active member of the El Dorado CNPS.

Now is the time to get involved. If you want to run, before Nov. 14 call Susan at (530) 626-6736 or email her at [durhamsus@yahoo.com](mailto:durhamsus@yahoo.com).

Susan Durham will also take proxy votes if you are unable to attend the Nov. 18 meeting.

## SAVE THE DATE GROWING NATIVES: CELEBRATING CALIFORNIA'S BEAUTY IN DRY TIMES

Two day Symposium—March 28, 2009 at Lafayette Community Center, Lafayette, and March 29, 2009 at Regional Parks Botanic Garden, Berkeley

Co-sponsored by *Pacific Horticulture*, the California Native Plant Society and the Friends of the Regional Parks Botanic Garden

We are pleased to present a 2-day program of talks and workshops exploring the possibilities for creating beautiful waterwise gardens with plants native to California.

For more information, please visit:  
[www.nativeplants.org](http://www.nativeplants.org)  
[www.cnps.org](http://www.cnps.org)  
[www.pacifichorticulture.org](http://www.pacifichorticulture.org)

## LOOKING FOR A HOSPITALITY VOLUNTEER

Is anyone out there interested in being in charge of hospitality? The duties mainly entail coordinating refreshments for our monthly meetings. If you can commit to do this job for three months minimum, please contact Susan Durham, (530) 626-6736, [durhamsus@yahoo.com](mailto:durhamsus@yahoo.com).

## NOVEMBER PROGRAM MEMBER POTLUCK AND PHOTO SHOW

Join us for good food and good fellowship at our annual potluck! Bring (optional) food to share, photographs (hardcopy, CD, flashdrive, slides) from your plant adventures in 2008, and/or plant that you want identified.

## JANUARY PROGRAM NFGEL AND NATIVE PLANTS

Valerie Hipkins, Director of the National Forest Genetics Laboratory (NFGEL), will talk to us about work that her program does with native plants. NFGEL is often asked to assist with projects that involve native plants. The objectives of these projects usually involve questions about the taxonomy of plant occurrences, the restoration or conservation of a species or population, and/or seed or germplasm movement. Much of our genetic data is used (1) to identify appropriate plant species or subspecies, (2) to see if introduced material is disrupting local gene pools, (3) to measure and maintain original levels of genetic diversity, (4) to identify intra- and interspecific hybridization and introgression ("genetic contamination"), and (5) to measure existing levels of variation to maintain original genetic structure and levels of genetic diversity.

Much of NFGEL's recent work reflects land manager's increasing interest in using native plants. Native plants are preferred not only because they are part of our natural heritage, but also because they perform impor-

Beverages, utensils, cups, plates, a laptop computer and a digital projector will be provided. Please let Susan know in advance if you need a slide projector by calling (530) 626-6736 or email her at [durhamsus@yahoo.com](mailto:durhamsus@yahoo.com).

This event will be held at 6:30 pm, Nov. 18, at the Placerville County Public Library at 345 Fair Lane, Placerville.

tant functions in native ecosystems and promote healthy environments. Genetic information increases our understanding of native species and provides clearer management direction. Valerie will give specific examples of how we have used genetic data in the management of several native species including: *Silene campanulata* (catchfly), *Erysimum menziesii* (wallflower), and *Oenothera wolfii* (evening-primrose).

Valerie received her Bachelor of Science in Forestry from Humboldt State University, and her Master of Science in Forest Science (tree physiology) and Ph.D. in Genetics and Forestry from Oregon State University. She joined the Forest Service in 1993 and is the Director of the National Forest Genetics Laboratory (NFGEL) located at the Institute of Forest Genetics in Placerville, California. NFGEL provides genetic testing and information for integrated solutions to on-the-ground problems faced by natural resource managers and policy makers. Information about genetics helps assess past, current and future biological changes, and provides implications for management options in the future.

This event will be held at 7:00 pm, January 20, at the Placerville County Public Library at 345 Fair Lane, Placerville.

*Strategies & Solutions*



CONSERVATION  
CONFERENCE

## CNPS CONSERVATION CONFERENCE 2009

JANUARY 17-19, SACRAMENTO, CALIFORNIA

CNPS is hosting a conference to identify and promote science- and policy-based strategies and solutions to improve the conservation of California's native flora and natural landscapes. Conference activities include key note speakers, presentations, and posters sessions. This is an opportunity to listen to leaders in native plant conservation and to meet others interested in protecting our flora. For details go to: <http://www.cnps.org/cnps/conservation/conference/2009/> *El Dorado chapter is offering limited financial assistance to active members who would like to attend. Call Cindy at (530) 642-0648 for more info or if you want to carpool.*



El Dorado Chapter  
 California Native Plant Society  
 P.O. Box 1948  
 Placerville, CA 95667

November-December 2008

Learn more about State CNPS at: [www.cnps.org](http://www.cnps.org)



**DEDICATED TO THE PRESERVATION OF CALIFORNIA'S NATIVE FLORA**

The California Native Plant Society is a statewide nonprofit organization of amateurs and professionals with a common interest in California's native plants. The mission of the Society is to increase understanding and appreciation of California's native plants and to preserve them in their natural habitat through scientific activities, education, and conservation. Membership is open to all.

Membership includes the quarterly journal, *Fremontia*, the quarterly *Bulletin*, which gives statewide news and announcements of Society activities and conservation issues, and the chapter newsletter *Gold Field Notes*. To join, call our main office in Sacramento, (916) 447-2677, or visit [www.cnps.org](http://www.cnps.org) to join online.

**CHAPTER OFFICERS AND COMMITTEE CHAIRS**

PRESIDENT	Amy Hoffman	(530) 676-1916	AmyHof@gmail.com
VICE PRESIDENT	Armond Chase	(530) 620-7006	chasemtkm@aol.com
SECRETARY	Joanne Geggatt	(916) 939-3394	joannegeggatt@sbcglobal.net
TREASURER	Cindy Podsiadlo	(530) 642-0648	clpodsiadlo@yahoo.com
BOOKS AND POSTER SALES	Marty Oberlander	(530) 333-1536	mober44@sbcglobal.net
CLARK YOUTH FUND PROGRAM	Rosemary Carey	(530) 620-3631	rosemarycarey@innercite.com
CONSERVATION	Sue Britting	(530) 295-8210	britting@earthlink.net
Field Trips	Shellie Perry	(530) 644-6335	seperry@concentric.net
HOSPITALITY	Vacant		
INVASIVE EXOTICS	Annie Walker		botanist@d-web.com
MEMBERSHIP	Ben Parks	(530) 626-8889	baparks38@directcon.net
PLANT SALES	Shellie Perry	(530) 644-6335	seperry@concentric.net
PROGRAMS	Susan Durham	(530) 626-6736	durhamsus@yahoo.com
PUBLICITY	Rich Wade	(530) 644-7210	rwade@spi-ind.com
WEB MASTER	Steve Tyron	(530) 622-6567	steve@TyronGraphicDesign.com
NEWSLETTER EDITOR	Sue Britting	(530) 295-8210	britting@earthlink.net